

APSB2 Tub Buddy - bathing transfer system

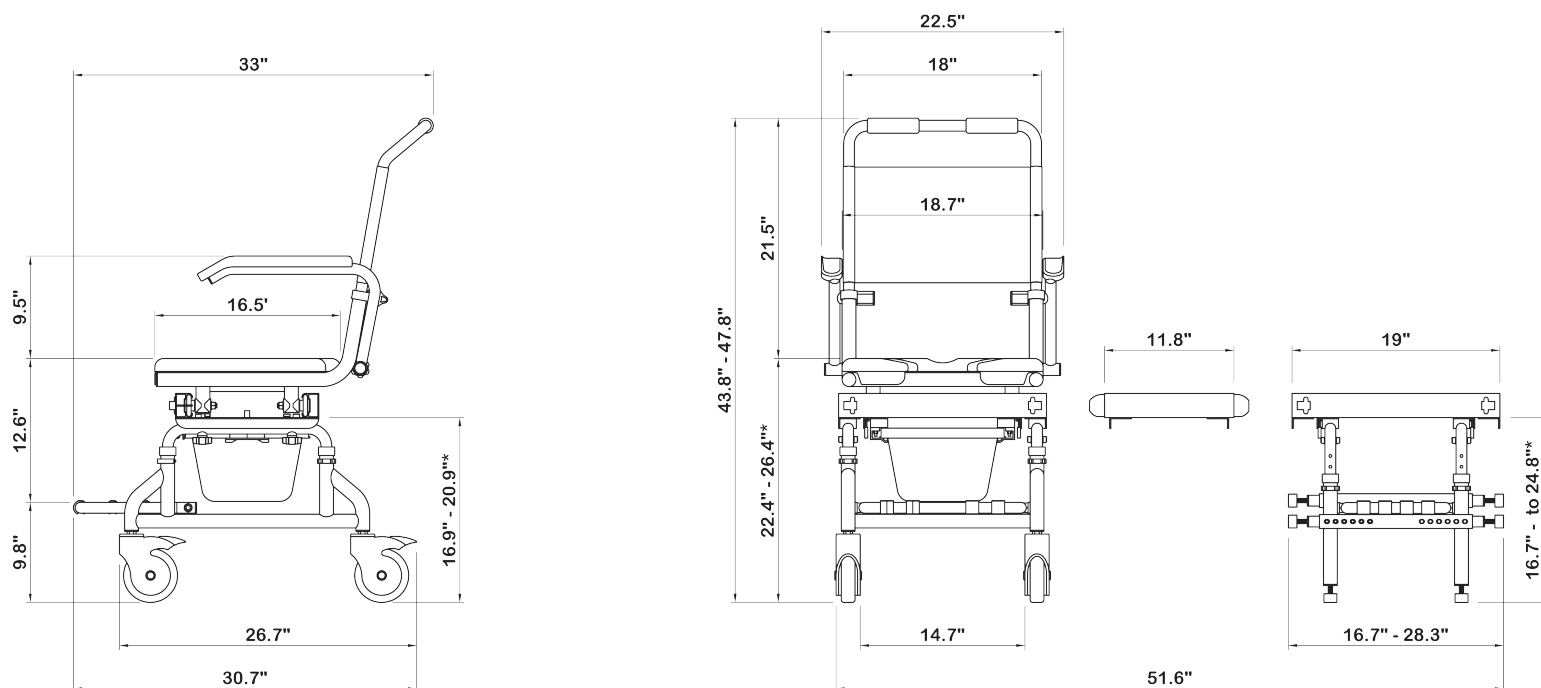

PRODUCT SPECS	WEIGHTS & DIMENSIONS
Weight Limit	350 lb (160kg)
Rolling Base (W x D)	19.3" x 26.7" (490mm x 680mm)
Rolling Base including Footrest	19.3" x 30.7" (490mm x 780mm)
Outer Armrest Width	22.5" (570mm)
Inner Armrest Width	18.7" (475mm)
Inner Width Between Main Legs	15.7" (400mm)
Backrest Width	18" (460mm)
Back Rest Height from Cushion	17" (440mm)
Toilet Height Clearance (Max)	19.4" (495mm)
Standard Bridge Length (Can Be Customized)	11.8" (300mm)
Seat Cushion WxD	17.7" x 16.5" (450mm x 420mm)
Seat Cushion Height from Floor (Adjustable)	22.4" - 26.4" (570mm - 670mm)
Seat Cushion Opening (W x L)	6.8" x 13" (175mm x 335mm)
Tub Base (Top) WxL	13.2" x 18.3" (335mm x 465mm)
Tub Base (side stabilizers)	16.7" - 28.3" (425mm - 720mm)

PRODUCT FEATURES	DETAILS
Armrests	Removable / Lockable / Flip-back
Height	Height Adjustable
Frame Metal	Corrosion resistant Aluminum frame (Grade 6061 T6)
Misc. Parts	Stainless steel parts and hardware (Grade 304)
Safety Belts	Lap & Chest Belts
Caster Wheels	5" (125mm) , Lockable
Commode	Removable Commode System