

# INSTALLATION INSTRUCTIONS

SSC-180180-PWS  
Contour Shower Seat  
LIFESTYLE & WELLNESS®

**PLEASE READ THESE INSTALLATION INSTRUCTIONS THOROUGHLY PRIOR TO INSTALLING THIS SHOWER SEAT**

**IMPORTANT: THIS PRODUCT SHOULD ONLY BE INSTALLED BY QUALIFIED AND TRAINED PERSONNEL**

FAILURE TO FOLLOW THESE INSTRUCTIONS COULD LEAD TO IMPROPER INSTALLATION OF THE SHOWER SEAT, STRUCTURAL AND/OR WATER DAMAGE TO THE WALL AND IN-WALL SUPPORT STRUCTURES, AND/OR SERIOUS BODILY INJURY IN USE. IN ADDITION, ALL WARRANTIES, EXPRESS OR IMPLIED, WILL BE NULL & VOID DUE TO IMPROPER INSTALLATION OF THIS PRODUCT. THE MANUFACTURER DOES NOT ASSUME ANY LIABILITY FOR DAMAGE RESULTING FROM SERVICES PERFORMED BY OTHERS, OR FAULTY INSTALLATION, MISUSE OR MISAPPLICATION OF GOODS.

THIS PRODUCT IS DESIGNED TO MEET OR EXCEED ALL LOAD REQUIREMENTS ESTABLISHED IN THE FEDERAL SPECIFICATION #WW-P-541/8b AT 250 POUNDS OF FORCE. THE PERFORMANCE OF THIS PRODUCT IS SIGNIFICANTLY IMPACTED BY THE STRENGTH OF THE WALL TO WHICH IT IS ATTACHED.

TO ASSURE PROPER AND SAFE INSTALLATION, THIS SHOWER SEAT MUST BE INSTALLED INTO A MINIMUM 2" THICK, SOLID WOOD, IN-WALL BACKING MATERIAL. MAKE CERTAIN IN-WALL BACKING COMPLIES WITH ALL LOCAL BUILDING CODE REQUIREMENTS.

**MAXIMUM WEIGHT CAPACITY FOR THIS PRODUCT IS 250 LBS. WHEN PROPERLY INSTALLED.**

1. Remove the Contour Shower Seat (SSC-180180-PWS) from the shipping carton.

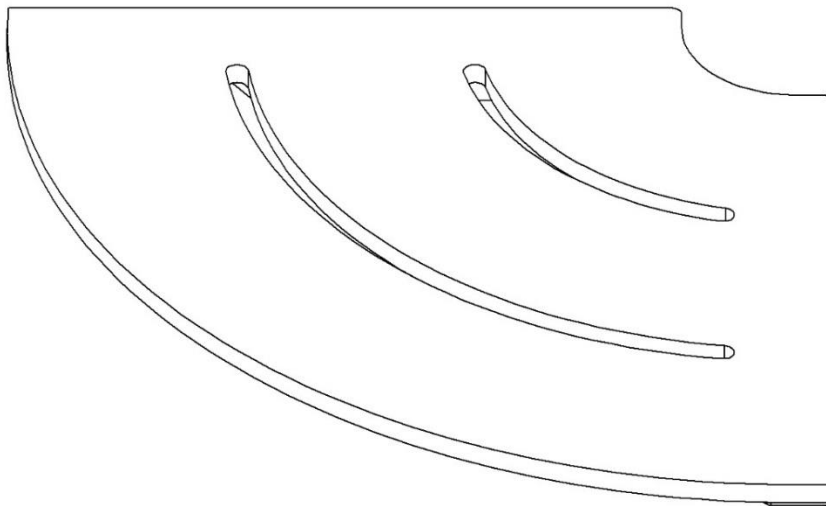

## 2. Locating the Contour Shower Seat in the desired position for Walk-in Showers.

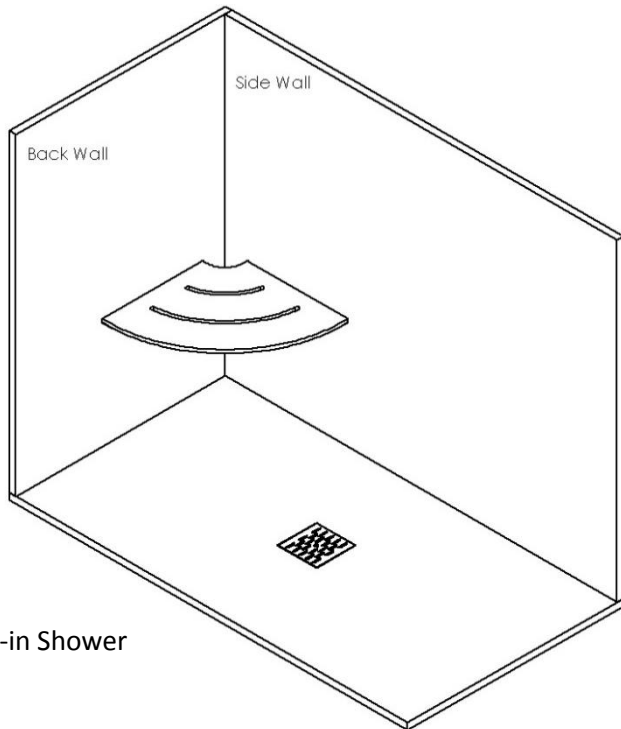

Walk-in Shower

Locate and ensure the area where the seat is to be mounted is reinforced with 2" solid wood in-wall backing. Determine desired seat height (ADA requirements stipulate a seat height of 17" – 19" from the floor). Using the seat as a template, align the hole centerlines with the 2" solid wood in-wall backing.

When installing the seat in a tub enclosure, place the shower seat against the wall to ensure the bottom of the seat mounting brackets will clear the tub dam. Mark the top center of the mounting hole slots with a marking pencil/pen.

It is **extremely important** you mark the center of each of the six (6) mounting holes precisely on the mounting surface.

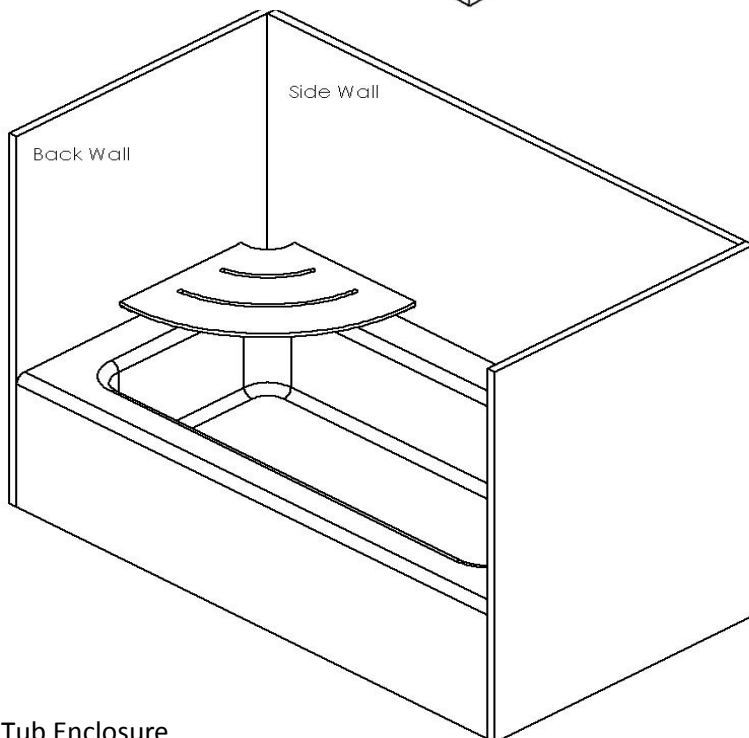

Tub Enclosure

# INSTALLATION INSTRUCTIONS

SSC-180180-PWS  
Contour Shower Seat  
LIFESTYLE & WELLNESS®

*Proceed cautiously through the following steps in this installation process to avoid drilling into in-wall water supply lines.*

**All mounting points must fasten into structural wood backing, minimum 2" thickness.**

**Avoid electrical and/or plumbing behind the wall, and where possible drill through tile – not through grout.**

### 3. Mounting the Contour Shower Seat.

#### Step #1

Using a 1/8" Carbide drill bit (not provided), create six (6) mounting holes at the locations marked on the wall into the 2" thick solid wood in-wall backing.

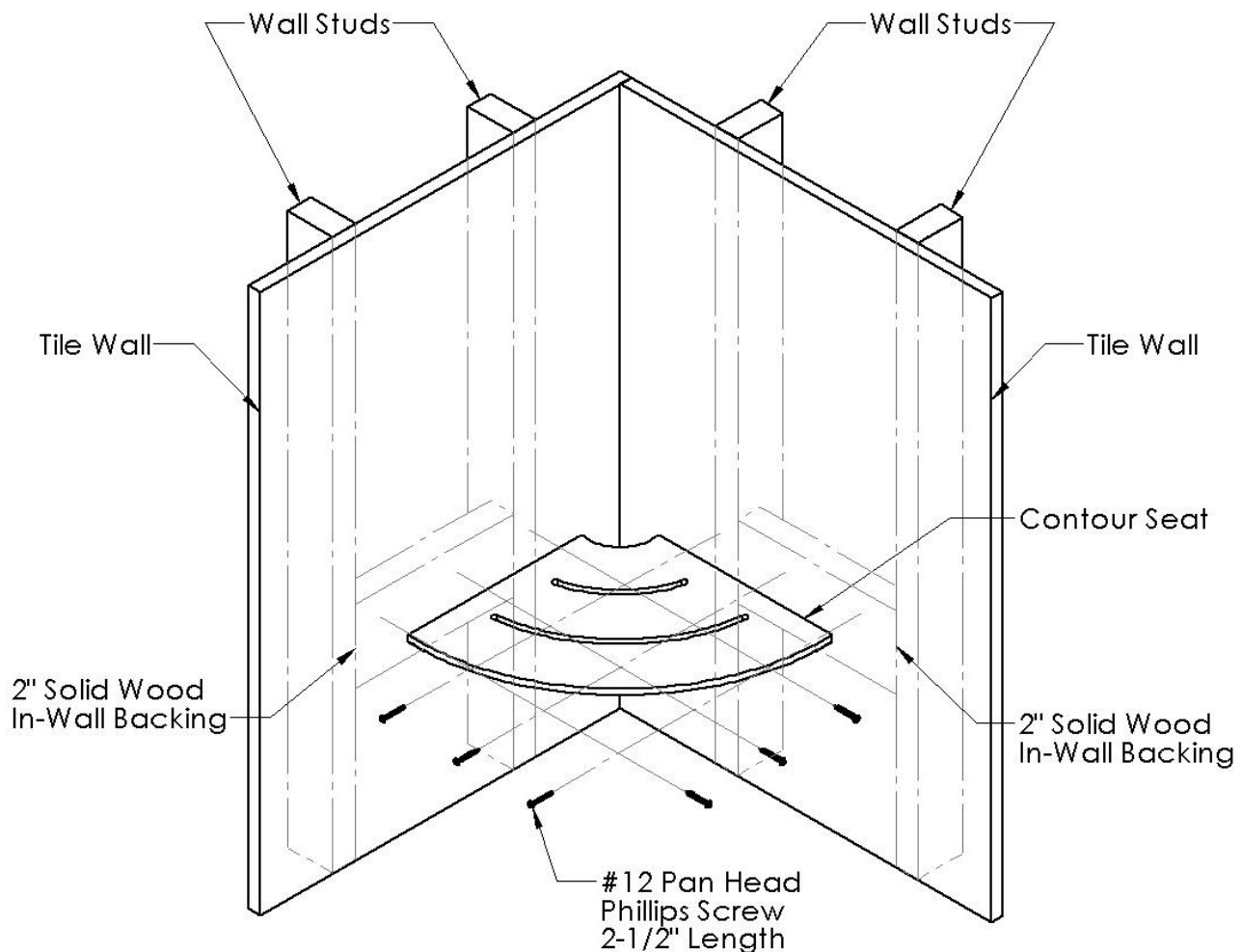

## Step #2

Secure the Seat Mounting Bracket to the wall using (6) #12 x 2-1/2" stainless steel screws (supplied by manufacturer) and screw **INTO 2" THICK, SOLID WOOD IN-WALL BACKING MATERIAL**.

*Do **NOT** tighten screws completely until ALL (6) screws are in place.*

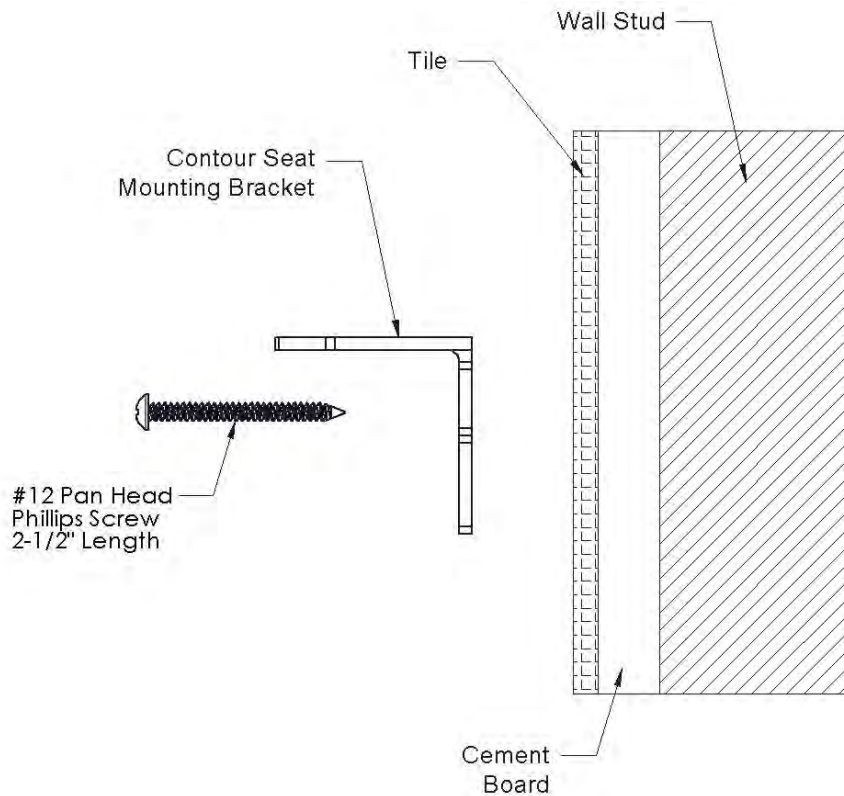

***To ensure proper and safe installation, the shower seat should not shift in any direction on the mounting surface.***

### Hardware Provided:

(6) #12 X 2-1/2" Phillips Pan Head sheet metal screws

### Tools required:

Marking pencil/pen, level, power drill, 1/8" Carbide tip drill bit, #3 phillips driver

***THIS COMPLETES THE INSTALLATION OF THE CONTOUR SHOWER SEAT.***