

Comfort Series SUBMITTAL DATA

FRONT VIEW

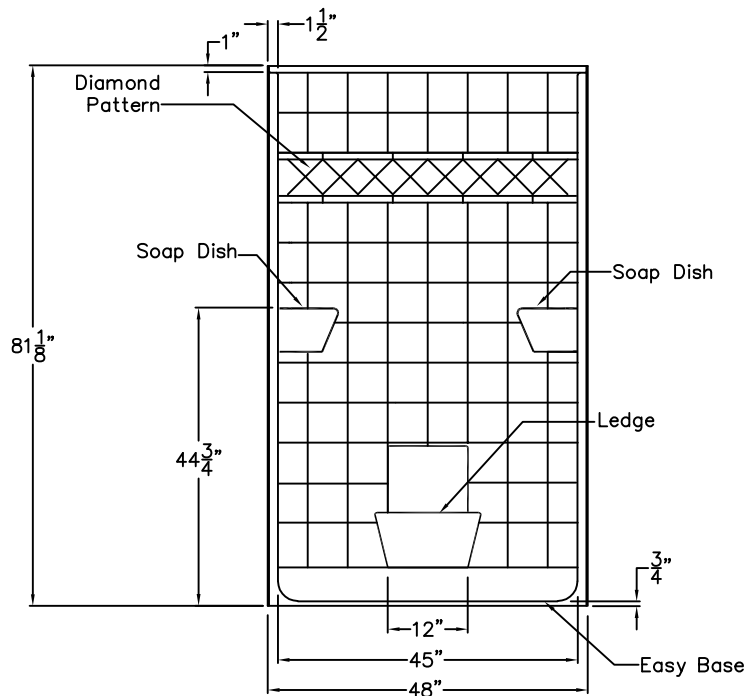

SIDE VIEW

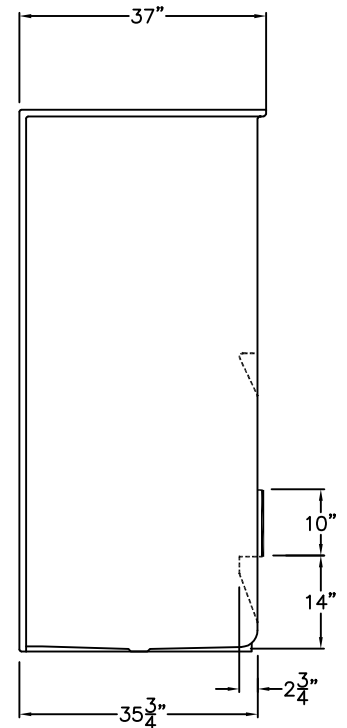

TOP VIEW

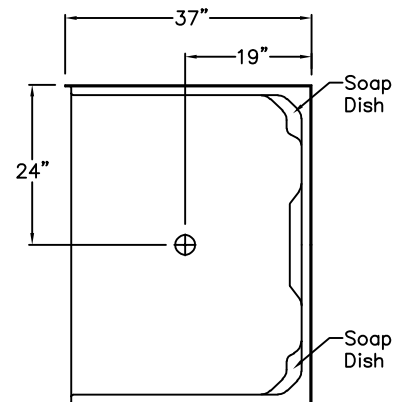

Accessible Shower Stall

The shower enclosure shall be Model APTXST 4836 BF left. Finished surface shall be of a sanitary grade applied acrylic. The base shall be attached to the sump of the unit in such a manner to form an integral part with an inner and outer coating of polyester resin. The unit shall have outside dimensions of 48" x 37" x 81 1/8". Unit complies with UPC, CSA B45.5, HUD-UM73, and ANSI Z124.1.2.

The enclosure shall be equipped with the following installed accessories:

- 1) Reinforced backing on the back wall for future horizontal grab bar, 2) Reinforced backing on the valve side wall for future horizontal and vertical grab bars, 3) Reinforced backing on the opposite side wall for future fold up seat (future bars and seats by others), 4) Tile finish, 5) Diamond accents, 6) Molded ledges on the back wall, 7) Armor Core Easy Base, 8) 3/4" threshold.

Available Options: 9) Grab bars, 10) Fold up Seat, 11) Curtain rod, 12) Valve plackage, 13) Nurses call box drilling, 14) Recessed soap dish.

Detail of 3/4" Threshold

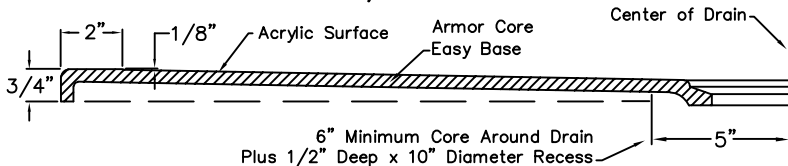

STATE HANDING WHEN ORDERING
HANDED BY THE VALVE
Left Hand Shown, Right Available

DUE TO THE NATURE OF THE MATERIALS
INVOLVED, UNIT DIMENSIONS MAY VARY
+ 1/2 INCH.

ACCESSIBILITY PROFESSIONALS

Approved By Print Name:

Drawing#: APTXST 4836 BF .75 FBP Easy Base

Approved By Signature:

Date:

Date: 6-22-07

Revised: 9-22-20

Rep.:

Wholesaler:

Quote No.:

Backing Placement Drawing

SUBMITTAL DATA

FRONT VIEW

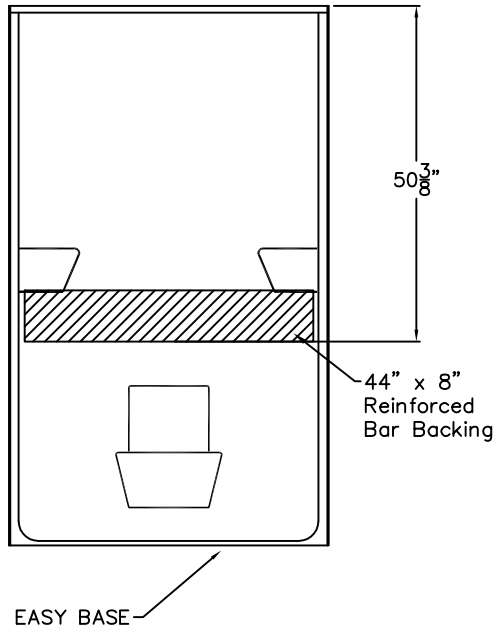

SIDE VIEW

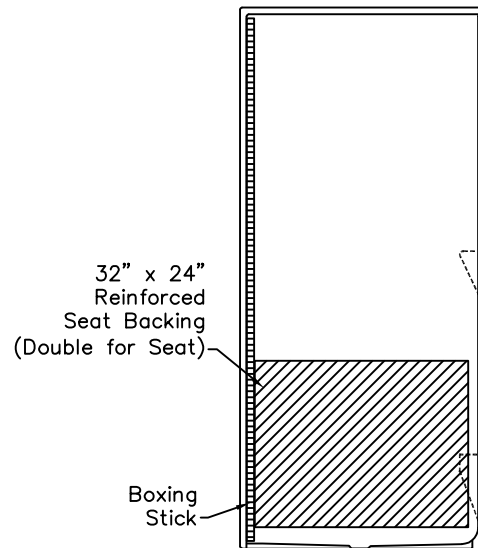

SIDE VIEW

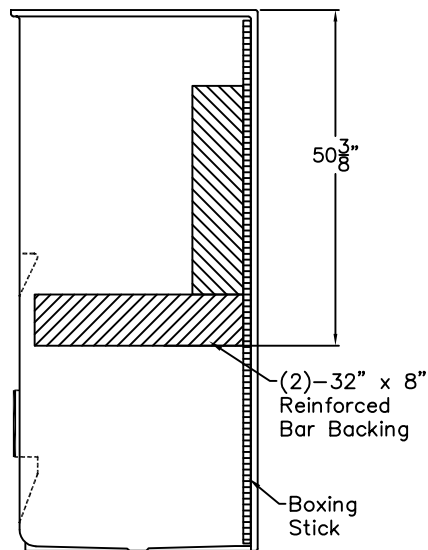

DUE TO THE NATURE OF THE MATERIALS INVOLVED, UNIT DIMENSIONS MAY VARY $\pm 1/2$ INCH.

Job Name:		ACCESSIBILITY PROFESSIONALS	
Approved by Print Name:		Drawing#: APTXST 4836 BF .75 FBP Easy Base-BP	
Approved by Signature:	Date:	Date: 6-20-07	Revised: 9-22-20
Rep.:	Wholesaler:	Quote No.:	